

Dimensions adapters BSP Parallel Thread (RS)

Compression type			1/8"BSPP	1/4"BSPP	1/2"BSPP	1"BSPP
			A	A	A	A
adapter	3 mm	OD	25.3	26.1		
adapter	6 mm	OD	27.6	28.4	29.2	
adapter	8 mm	OD	28.6	29.4	30.2	
adapter	10 mm	OD		30.2	31.0	
adapter	12 mm	OD	32.2	32.5	33.5	
adapter	15 mm	OD			33.6	
adapter	16 mm	OD			33.5	
adapter	18 mm	OD			34.8	
adapter	20 mm	OD			36.5	
adapter	25 mm	OD			42.0	41.7
adapter	1/16"	OD	20.6			
adapter	1/8"	OD	25.3	26.1		
adapter	1/4"	OD	27.6	28.4	29.2	
adapter	3/8"	OD	29.5	29.9	30.7	
adapter	1/2"	OD		32.7	33.5	
adapter	3/4"	OD			34.8	
adapter	1"	OD			41.6	41.7

BSP Parallel Thread (RS)
Compression type

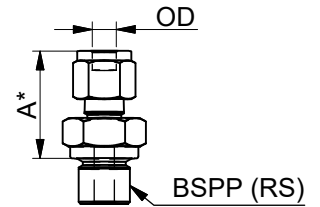

*) Dimension A is typical finger-tight.

O-ring face-seal			1/8"BSPP	1/4"BSPP	1/2"BSPP
			A	A	A
adapter	1/4"	In-/Outlet	19.8	19.8	
adapter	1/2"	In-/Outlet		22.8	22.8
adapter	3/4"	In-/Outlet			25.3

BSP Parallel Thread (RS)
O-ring face-seal

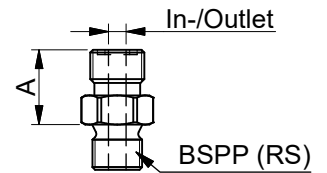

tol. dimension A = ± 0.1

Face-seal			1/8"BSPP	1/4"BSPP	1/2"BSPP
			A	A	A
adapter	1/8"	In-/Outlet	17.8	19.3	
adapter	1/4"	In-/Outlet	23.7	23.2	
adapter	1/2"	In-/Outlet		27.8	27.6
adapter	3/4"	In-/Outlet			36.5

BSP Parallel Thread (RS)

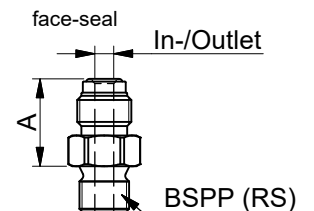

tol. dimension A = ± 0.1

Tri-clamp DIN32676-B		A	OD	ID	BSPP
adapter	DN/OD 13.5	25	25	10.3	1/4"
adapter	DN/OD 21.3	25	50.5	18.1	1/2"

BSP Parallel Thread (RS)

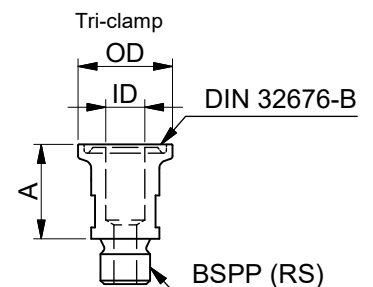

tol. dimension A = ± 0.2